



ENVIRONAMICS

DYNAMIC OFFICE ENVIRONMENTS

13935 SOUTH POINT BLVD
CHARLOTTE, NC 28273

REQUEST FOR QUOTATION

Glass Wall System: Slimline

contact: John Varda @ 704.376.3613

email: jvarda@environamics-inc.com

In order to provide an accurate quotation for your project, we need to gather as much information as possible. Please fill out this form completely, and return it to us along with a floor plan and elevations. We accept AutoCAD files. The floor plan and elevations may be hand drawn, but they must either be drawn to scale or include accurate dimensions. Quotations are based on the information provided below. Any changes may result in a change in the quoted price.

Date: _____	Contact: _____
Dealer: _____	Project: _____
Phone: _____	Location: _____
Email: _____	Govt Contract: _____

Project Description:

Ceiling Height: _____	Feet and inches, measured if possible
Ceiling Type: _____	ACT ceiling, gypsum bulkhead, etc.
Floor Type: _____	Carpet, terrazzo, raised access, etc.

Ceiling Type:



Flush Tile



Reveal Tile



Dimensional T



Drywall or Bulkhead

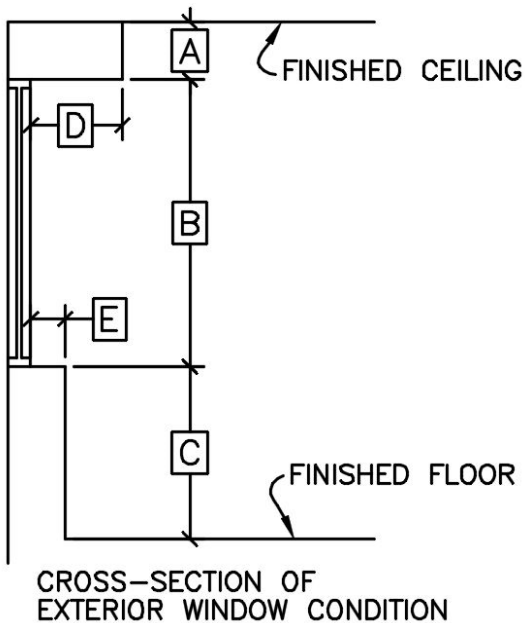

Exterior Window Conditions

A = _____

B = _____

C = _____

D = _____

E = _____

Other Pertinent Information:

Project Stocking & Staging Information:

Project is located on _____ floor

Loading dock is available Yes No Freight elevator is available Yes No

Note: Please supply freight elevator interior dimensions if available. An undersized freight elevator may result in an upcharge for stocking. _____

Product Specification:

1) Aluminum Trim Finish will be:

AN Clear Anodized (Standard)

Custom (Upcharge) to match: _____

2) Glazing Options:

1/2" Clear Tempered Glazing, Clear Acrylic Glazing Bead (Standard)

1/2" Clear Laminated Glazing, Clear Acrylic Glazing Bead

Custom Glass Requirements (Describe): _____

3) Door & Hardware Type:

Full Height Frameless Glass Pivot Door	Locking Hardware	Non-Locking Hardware
<i>Standard: Top & Bottom Patch Pivots, 48" Non-Locking Straight Pull, Stainless</i>		Automatic Closer

Full Height Frameless Glass Sliding Door	Locking Hardware	Non-Locking Hardware
♦ Please include door and hardware specification if available.		

4) Accommodation for Digital Scheduling Signage: Yes No

Installation Information

Environamics to provide installation Yes No

Dealer to provide installation Yes No

Environamics to provide installation supervision Yes No

After-hours or weekend installation is required Yes No

Reconfigure of existing product is required Yes No

(Note: Environamics is non-union)

Other comments or information not covered above:

Thank you for the opportunity to provide a quotation for your project. Your Request for Quotation will be directed to the Project Manager for your region, who will contact you upon receipt.