

# ENVIRONAMICS

DYNAMIC OFFICE ENVIRONMENTS

13935 SOUTH POINT BLVD  
CHARLOTTE, NC 28273

# REQUEST FOR QUOTATION

Movable Wall System: Symbio®

contact: John Varda @ 704.376.3613

email: jvarda@environamics-inc.com

In order to provide an accurate quotation for your project, we need to gather as much information as possible. Please fill out this form completely, and return it to us along with a floor plan and elevations. We accept AutoCAD files. The floor plan and elevations may be hand drawn, but they must either be drawn to scale or include accurate dimensions. Quotations are based on the information provided below. Any changes may result in a change in the quoted price.

Date: _____	Contact: _____
Dealer: _____	Project: _____
Phone: _____	Location: _____
Email: _____	Govt Contract: _____

### Project Description:

Ceiling Height: _____	Feet and inches, measured if possible
Ceiling Type: _____	ACT ceiling, gypsum bulkhead, etc.
Floor Type: _____	Carpet, terrazzo, raised access, etc.

### Ceiling Type:



Flush Tile



Reveal Tile



Dimensional T



Drywall or Bulkhead

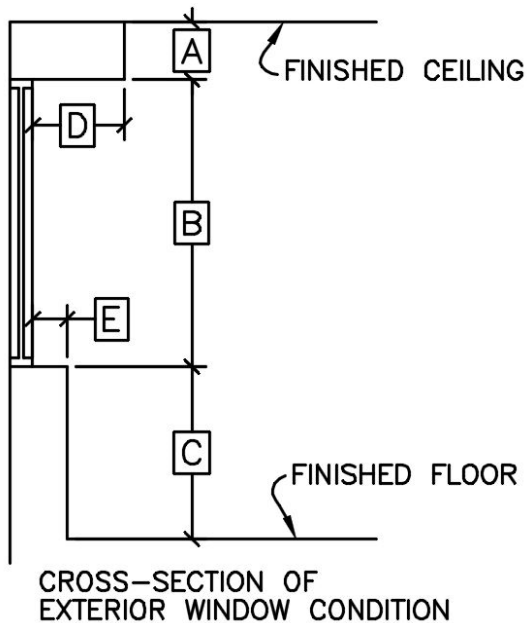

### Exterior Window Conditions

A =	_____
B =	_____
C =	_____
D =	_____
E =	_____

### Other Pertinent Information:

**Project Stocking & Staging Information:**

Project is located on \_\_\_\_\_ floor

Loading dock is available      Yes      No      Freight elevator is available      Yes      No

**Product Specification:**

1) Panel Surface Finish will be \_\_\_\_\_ (vinyl or fabric number & description)

*If multiple fabrics or other panel finishes are to be used, elevation drawings may be required to show size and location on panels.*

2) Aluminum Trim Finish will be:

- |                   |                           |                    |                       |
|-------------------|---------------------------|--------------------|-----------------------|
| BU Black Umber    | CL Cool Grey Neutral      | LT Light Tone      | LU Soft White         |
| MT Medium Tone    | WB Sand                   | HT Inner Tone      | HF Inner Tone Light   |
| SG Slate Grey     | HH Inner Tone Light Light | EH Metallic Bronze | CN Metallic Champagne |
| AN Clear Anodized | MK Bronze Anodized        | Other (To Match)   | _____                 |

3) \*Vinyl Base Trim Finish will be:

- |                |                      |               |               |
|----------------|----------------------|---------------|---------------|
| BU Black Umber | CL Cool Grey Neutral | SG Slate Grey | LU Soft White |
| MT Medium Tone | WN Warm Grey Neutral | HT Inner Tone |               |

4) \*Vinyl Base height will be:

- |             |               |   |
|-------------|---------------|---|
| 4" (Smooth) | 6" (Textured) | *Aluminum Base Trim is available – please discuss |
|-------------|---------------|---|

5) Glazing Options:

- |                                  |  |
|----------------------------------|--|
| Door Sidelight – Single Lite     | Modular Single Glass Panel                   |
| Door Sidelight – Multi-Lite      | Modular Multi-Lite Glass Panel               |
| Gypsum Panel w/ Clerestory Glass | Modular Panel w/ Solid Insert & Glass Insert |

*Standard glass will be priced. Various glass finishes are available. Please call to discuss.*

Special Window – describe:

6) Furniture will hang from the wall. Provide scaled furniture layout.

- |               |        |           |                       |
|---------------|--------|-----------|-----------------------|
| Action Office | Canvas | Ethospace | Other (Specify) _____ |
|---------------|--------|-----------|-----------------------|

7) Acoustical batting is required in panel chase      Yes      No

8) Power, tele/data and switch accommodations to be included (provide locations on plan)

- Standard vertical electrical options in gypsum panels
- 4 circuit / 8 wire modular raceway electrical system
- Tele/data requirements (base cut-outs to accommodate devices by others)
- Light switches (boxes by Environamics, devices and hook-up by others)
- Other accommodations – for card readers, thermostats, etc.

Location of building power connection	Ceiling J-Box	Floor J-Box	Wall/Column
---------------------------------------	---------------	-------------	-------------

**Door and Door Hardware Specification**

9) Door Type

- |                               |                              |
|-------------------------------|------------------------------|
| Full Height Swinging Door     | Full Height Sliding Door     |
| Partial Height Swinging Door  | Partial Height Sliding Door  |
| Frameless Glass Swinging Door | Frameless Glass Sliding Door |

10) Door Finish

- |   |                       |
|---|-----------------------|
| Paint Grade (to match color sample)           | Small View Window     |
| Wood Veneer (specify, to match finish sample) | Half Door View Window |
| Laminate (specify, to match finish sample)    | Full Door View Window |

11) Hardware Type & Function

Sliding Door Pull	Locking	Non-locking	Standard to be priced
<i>Note: Specify sliding door pull type and length if known:</i>			
Swinging Door Lockset	26D Satin Chrome	Other finish (specify)	_____
Swinging Door Passage Set	26D Satin Chrome	Other finish (specify)	_____

**Installation Information**

Environamics to provide installation	Yes	No
Dealer to provide installation	Yes	No
Environamics to provide installation supervision	Yes	No
After-hours or weekend installation is required	Yes	No
Reconfigure of existing product is required	Yes	No

(Note: Environamics is non-union)

**Other comments or information not covered above:**

*Thank you for the opportunity to provide a quotation for your project. Your Request for Quotation will be directed to the Project Manager for your region, who will contact you upon receipt.*